

Divisible differential current transformer

111.7079.23 - 58 - 812

- ▶ For residual current measurement for PQI-DE in the range 0... 18 A with RCM option D1

1. Use

The 111.7079 differential current sensors have been designed for use with the PQI-DE power quality analyser for accurate, differential current measurement via the RCM channel. Using the latest transformer technology, the 111.7079 series transducers can measure smallest fault currents occurring in the event of a fault over a frequency range of up to 20 kHz. Due to the separable design, retrofitting is possible with little assembly effort.



2. Technical data

Current range I_N	: 10 A AC RMS
Measuring range	: up to 18 A RMS
Translation ratio	: 600:1
Design burden	: 100..180 Ω
Frequency range	: 30 Hz to 20 kHz
Voltage range	: 0..720 V

3. General properties

Max. cross section	:	4 mm ²
Max. length wire	:	1 m (single core wire) 10 m (single core wire, twisted) 30 m (shielded cable)
Operating temperature	:	-5 to +45 °C
Storage temperature	:	-25 to +70 °C
Weight	:	700g-1400g

4. Connection

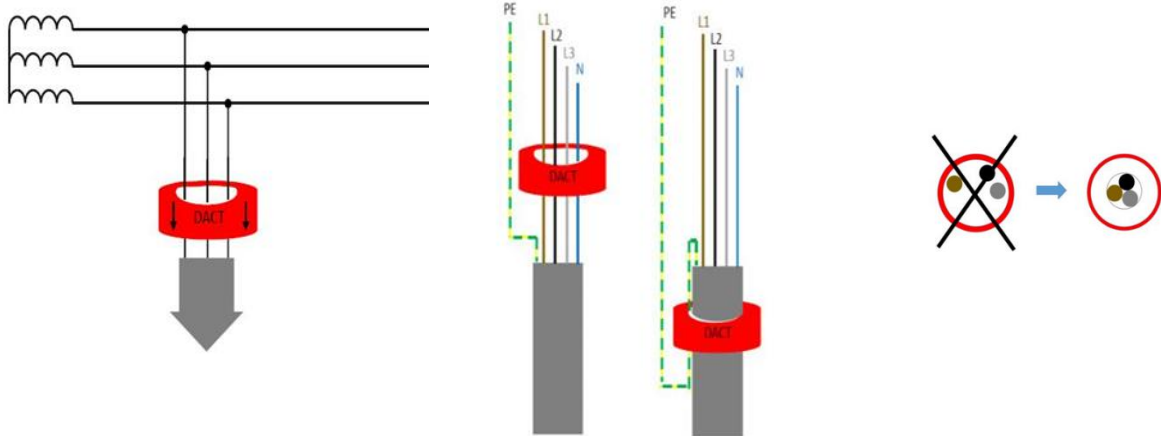

When installing the transducers, the routing direction of the individual lines must be observed!

Existing protective conductors must not be routed generally through the residual current transformer!

It must be ensured that all conductors (phase and neutral) are generally routed through the transformer!

To ensure the highest possible measuring accuracy, make sure that all conductors to be measured are arranged as centrally as possible in the primary conductor window of the transformer!

5. Safety

IEC 61869-1

IEC 61869-2

IEC 61010-1

600 V RMS , CAT III, Pollution Degree 3

Insulation test voltage: 3 kV

Protection class: Housing: IP 40; Terminals: IP 20

6. Dimensions

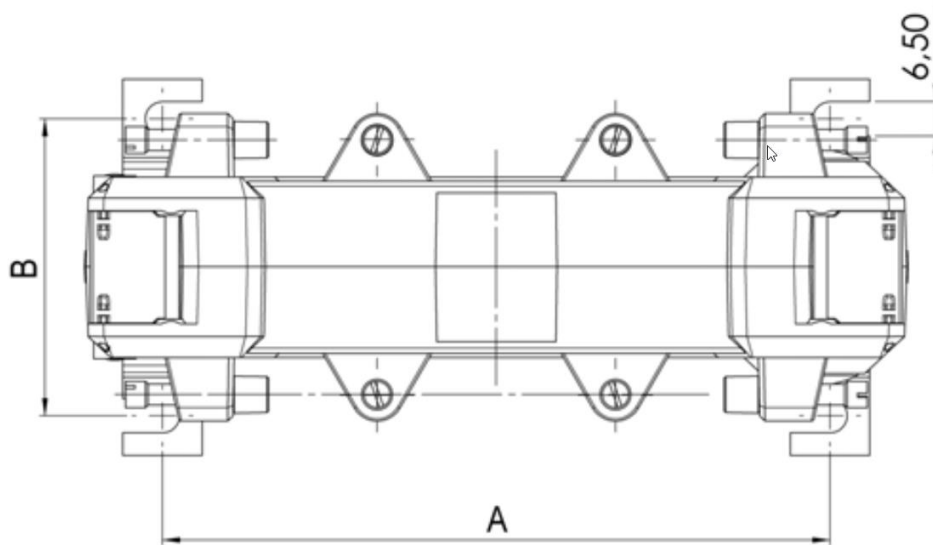

	111.7079.23	111.7079.58	111.7079.812
Primary conductor window	20 x 30 mm	50 x 80 mm	Ø 80 x120 mm
Width	93 mm	125 mm	155 mm
Height	106 mm	158 mm	198 mm
Dimension A	64 mm	30 mm	37 mm
Dimension B	56 mm	56 mm	56 mm
Weight	Approx. 700 g	Approx. 1100 g	Approx. 1400 g

7. Extended dimensions (in mm)

	111.7079.23	111.7079.58	111.7079.812
Width	93 mm	125 mm	155 mm
Height	106 mm	158 mm	198 mm
Dimension A	93 mm	125 mm	155 mm
Dimension B	106 mm	158 mm	198 mm
Dimension C/C1	34/58 mm	34/58 mm	34/58 mm
Dimension D	20 mm	55 mm	85 mm
Dimension E	30 mm	85 mm	125 mm
Weight	Approx. 700 g	Approx. 1100 g	Approx. 1400 g

8. Bestellungen

MERKMAL	IDENT-Nr.
Residual current sensor for highly accurate RCM measurement ● For 20 mm conductor; type A; clip-on mounting; single	111.7079.23
Residual current sensor for highly accurate RCM measurement ● For 35 mm conductor; type A; clip-on mounting; single	111.7079.58
Residual current sensor for highly accurate RCM measurement ● For 60 mm conductor; type A; clip-on mounting; single	111.7079.812

A. Eberle GmbH & Co. KG

Frankenstraße 160
D-90461 Nürnberg

Tel.: +49 (0) 911 / 62 81 08-0
Fax: +49 (0) 911 / 62 81 08 96
E-Mail: info@a-eberle.de

<http://www.a-eberle.de>

Version: 12/14/2021 8:48

Copyright 2021 by A. Eberle GmbH & Co. KG

Subject to change without notice.